



One and Six Year Plan Summary

City/Village: Blue Hill
Year: 2023

Plan Year	Project No.	Location	Description	Estimated Cost
One	M-160(73)	Gage St. - Pine St. to Hwy. 281	Existing armor coat road, driveways and sidewalks to 31' wide 6" concrete street with	\$ 391,000.00
One	M-160(80)	York St. - Sycamore St. to E. Railway; Williams St. - York St. S. approx. 200'	Existing bituminous road to 31' wide 6" concrete street with curb and gutter	\$ 254,000.00
One	M-160(100)	Maple St from Cherry St to Hickory St, Prospect Ave from Cherry St to Hickory St, Simpson Ave from Cherry St to Hickory St, &	Existing gravel road to 31' wide 6" concrete street with curb and gutter	\$ 905,000.00
One	M-160(101)	East Railway St. - York St. to Seward St. & Seward St. from East Railway St. to Sycamore St.	Existing gravel road to 31' wide 6" concrete street with curb and gutter & 30" concrete curb & gutter on north and south side of Seward St.	\$ 230,000.00
One	M-160(103)	Saline St. from Payne St. to Highway 281.	Existing asphalt road to 37' wide 6" concrete pavement with curb & gutter	\$ 182,000.00
Six	M-160(79)	York St. - Sycamore St. to approx. 130' east.	Existing gravel road to 31' wide 6" asphalt street with curb	\$ 71,000.00
Six	M-160(85)	Hickory St. - Seward St. to Saline St.	Existing gravel road to 24' wide 4" gravel road with curb and gutter	\$ 200,000.00
Six	M-160(93)	Webster St. from Lancaster St. to Seward St.	Existing gravel road to 31' wide 6" concrete street with curb and gutter	\$ 147,000.00
Six	M-160(94)	West Park Drive from Highway 281 west approx. 320 ft.	Existing gravel road to 31' wide 6" concrete street with curb and gutter	\$ 134,000.00
Six	M-160(95)	Cherry St. from southern corporate limits to alley between Maple and York St.	Existing gravel road to 31' wide 6" concrete street with curb and gutter	\$ 528,000.00
Six	M-160(96)	Ash St. from West Railway St. to York	Existing gravel road to 31' wide 6" concrete street with curb and gutter	\$ 398,000.00
Six	M-160(97)	Maple St. from Cherry St. to West Railway	Existing gravel road to 31' wide 6" concrete street with curb and gutter	\$ 360,000.00
Six	M-160(98)	Prospect Ave. from Cherry St. to West Railway St.	Existing gravel road to 31' wide 6" concrete street with curb and gutter	\$ 240,000.00
Six	M-160(99)	Simpson Ave. from Cherry St. to West Railway St.	Existing gravel road to 31' wide 6" concrete street with curb and gutter	\$ 101,000.00
Six	M-160(102)	Gage St. from Cherry St. to West Railway St.	Existing asphalt road to 31' wide 6" concrete street with 4' gravel shoulder	\$ 531,000.00
Total				\$ 4,672,000.00

BLUE HILL, NEBRASKA

ONE YEAR PLAN

2023

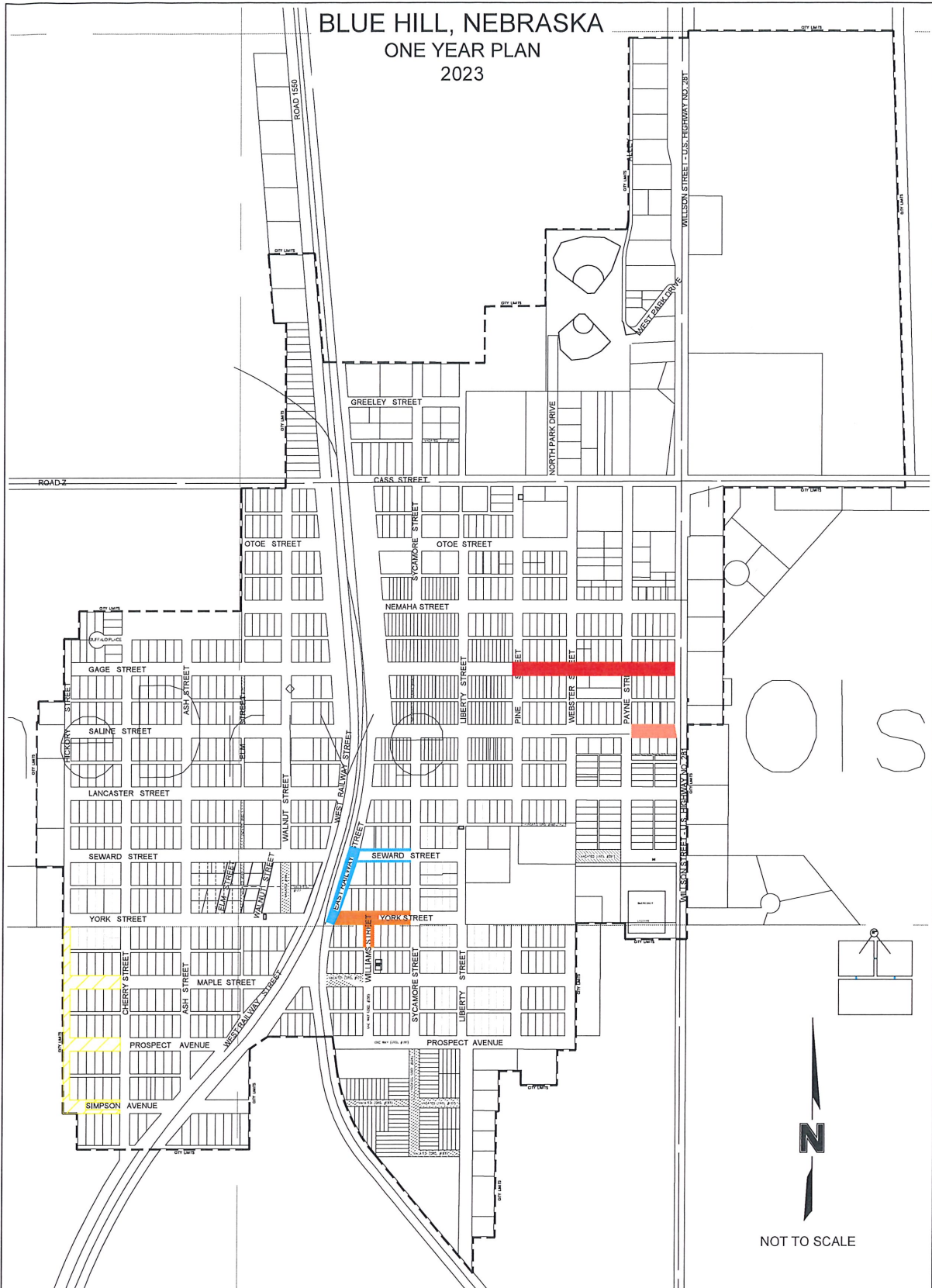

MAINTENANCE

- M-160 (73)
- M-160 (80)
- M-160 (100)
- M-160 (101)
- M-160 (103)

olsson

201 East 2nd Street
Grand Island, NE 68801 TEL 308.384.8750 www.olsson.com

BLUE HILL, NEBRASKA

SIX YEAR PLAN

2023

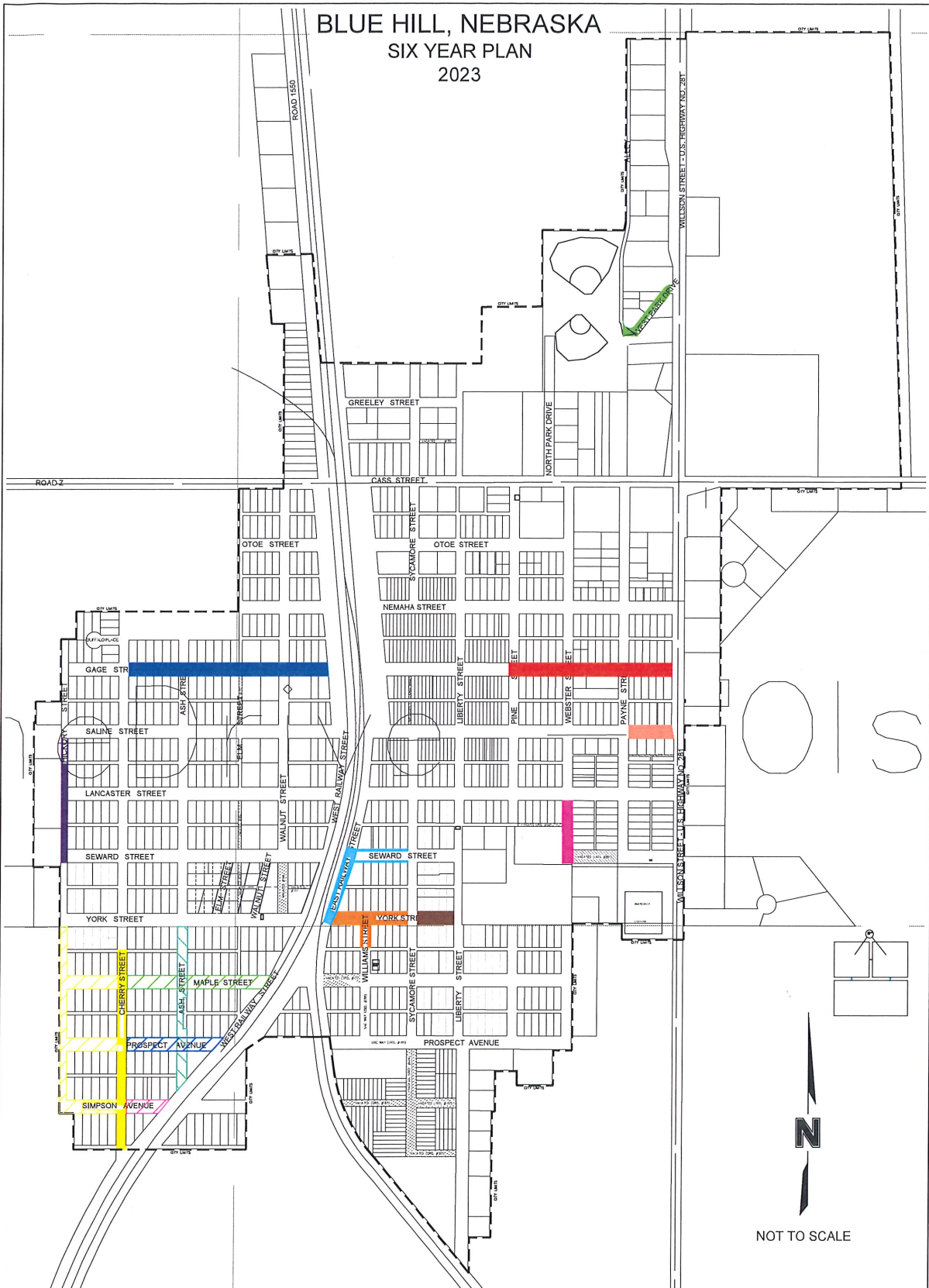

DWG: C:\temp\ad\bluehill_180201166_Ys_2023.dwg USER: bfridrichsen
DATE: Jul 18, 2023 1:50pm XREFS: emp\2023 Blue Hill

- | | | |
|---|---|---|
| M-160 (73) | M-160 (95) | M-160 (101) |
| M-160 (79) | M-160 (96) | M-160 (102) |
| M-160 (80) | M-160 (97) | M-160 (103) |
| M-160 (85) | M-160 (98) | |
| M-160 (93) | M-160 (99) | |
| M-160 (94) | M-160 (100) | |

olsson

201 East 2nd Street
Grand Island, NE 68801 TEL 308.384.8750 www.olsson.com